

HELGOLAND RECESSED

design
Carlotta de Bevilacqua

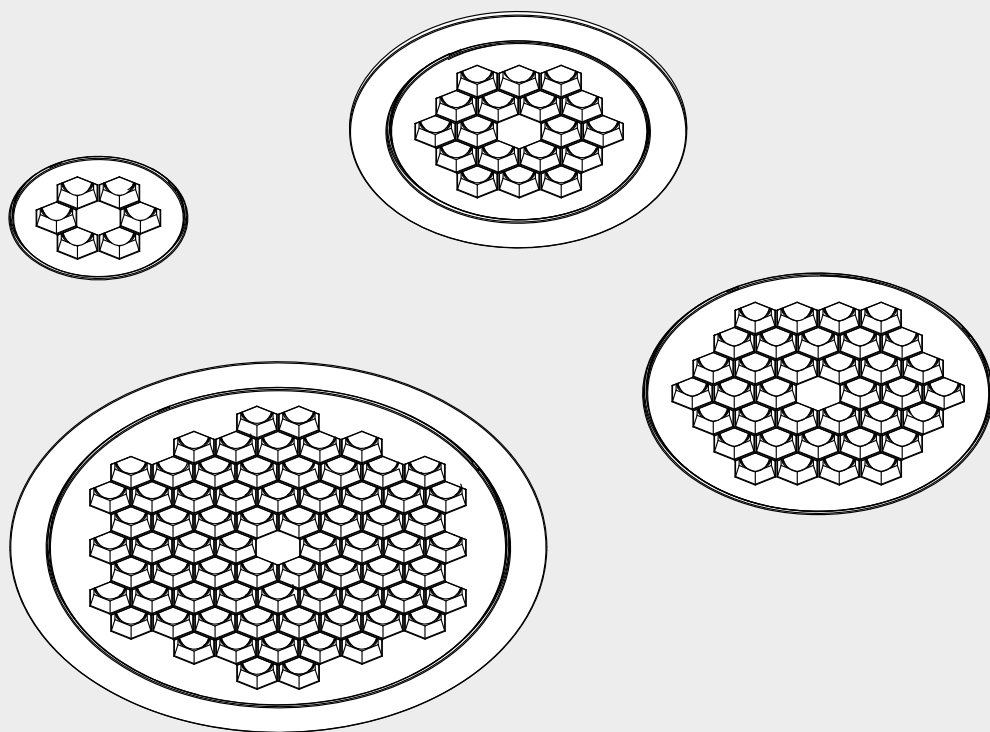

	CODES			FIXED II		
				Ø 60	Ø 90	
				AX00__4 AX01__4	AX05__4 AX06__4	
FRAMES FOR PLASTERBOARD THICKNESS = 12.5 mm	TRIM	Ø 60	AX5010_	✓		
		Ø 90	AX5510_		✓	
		Ø 120	AX6010_			
		Ø 160	AX6510_			
	TRIMLESS	Ø 60	AX50000	✓		
		Ø 90	AX55000		✓	
		Ø 120	AX60000			
		Ø 160	AX65000			
FRAMES FOR PLASTERBOARD THICKNESS ≠ 12.5 mm	TRIM	Ø 60	AX5210_	✓ + AX90500		
		Ø 90	AX5710_		✓ + AX90600	
		Ø 120	AX6210_			✓
		Ø 160	AX6710_			
	TRIMLESS	Ø 60	AX52000	✓ + AX90500		
		Ø 90	AX57000		✓ + AX90600	
		Ø 120	AX62000			✓
		Ø 160	AX67000			

HELGOLAND RECESSED SPOTLIGHTS

P20		FIXED IP44		ADJ	
Ø 120	Ø 160	Ø 90	Ø 120	Ø 90	Ø 120
AX10__4 AX11__4	AX15__4 AX16__4	AX92__4 AX93__4	AX94__4 AX95__4	AX07__4 AX08__4	AX12__4 AX13__4
		X		X	
✓			X		X
	✓				
		X		X	
✓			X		X
	✓				
		✓ + AX90600		✓	
✓ + AX90700			✓ + AX90700		✓
	✓ + AX90800				
		✓ + AX90600		✓	
✓ + AX90700			✓ + AX90700		✓
	✓ + AX90800				



i

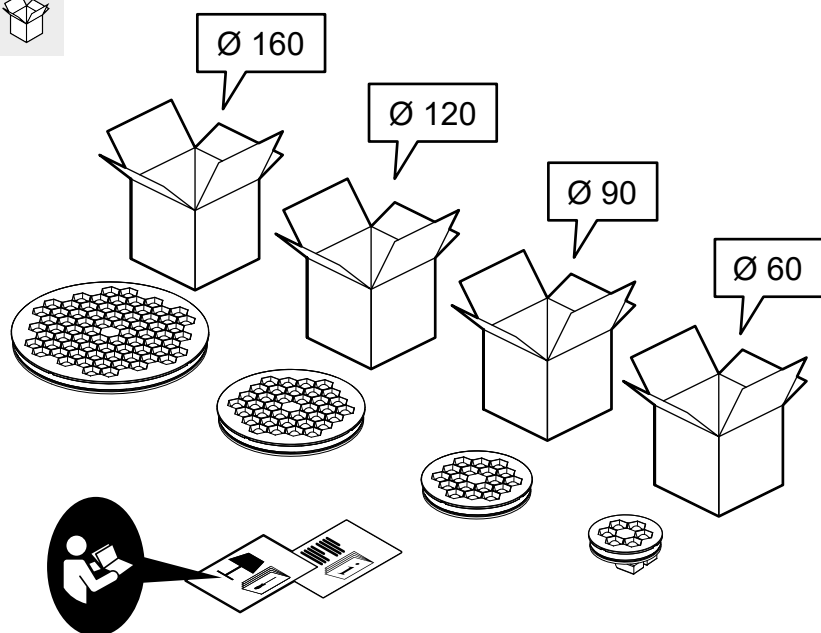
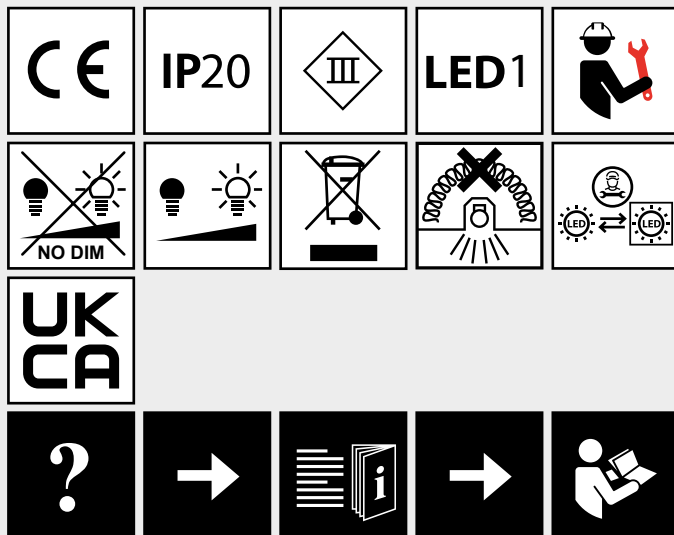



TRIM FRAME

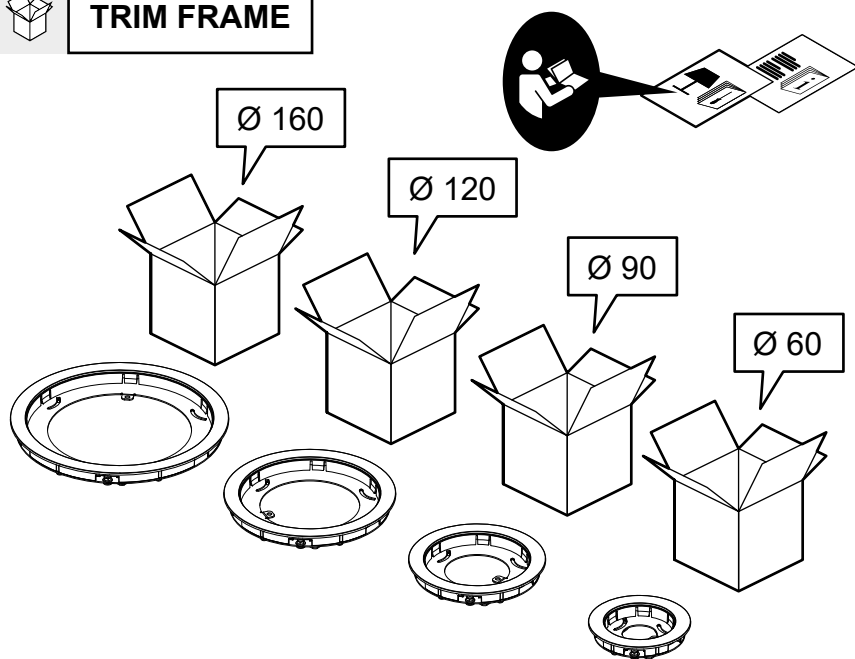

TRIMLESS FRAME

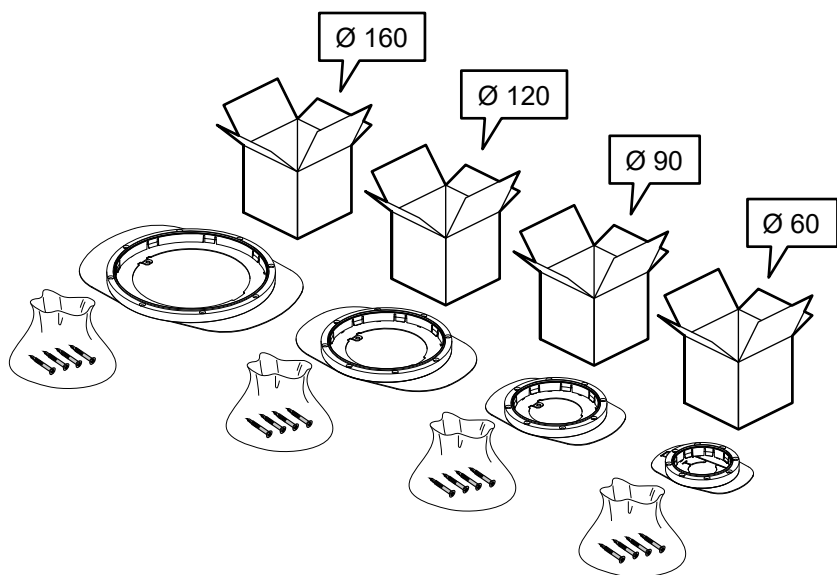



US / CANADA ONLY

AX90000

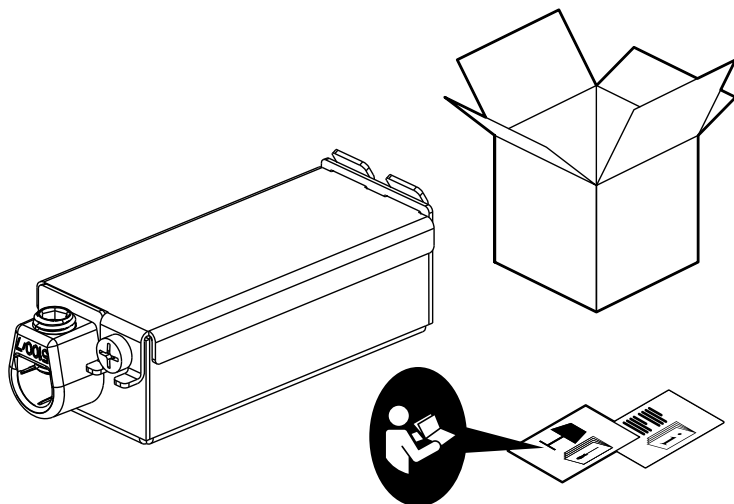



FRAMES FOR PLASTERBOARD THICKNESS **= 12.5 mm** **ONLY**

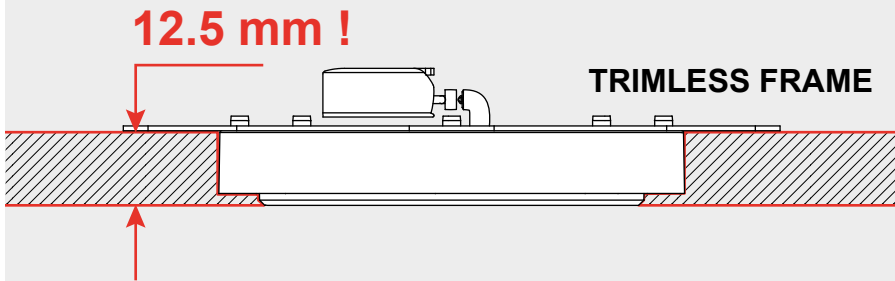
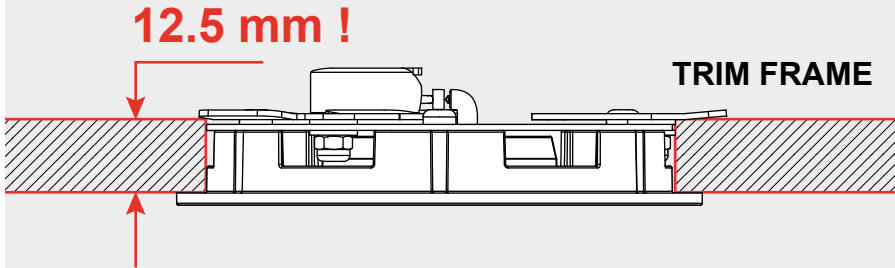

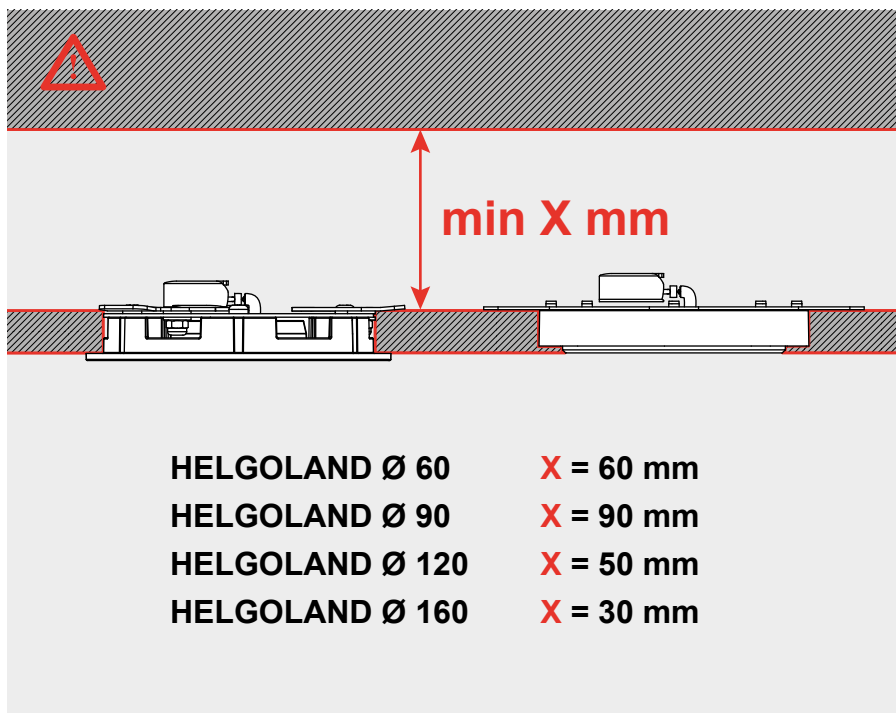

i

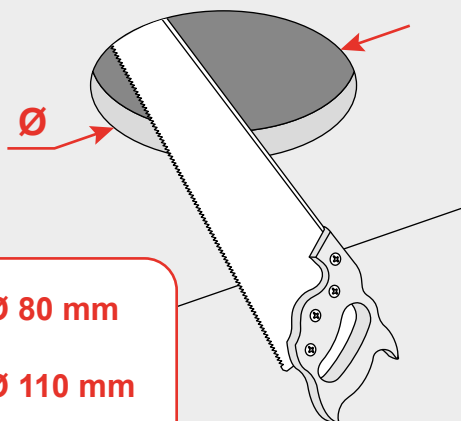

	Ø 60 → Ø 80 mm
	Ø 90 → Ø 110 mm
	Ø 120 → Ø 140 mm
	Ø 160 → Ø 180 mm

EU / WORLDWIDE

TRIM FRAME

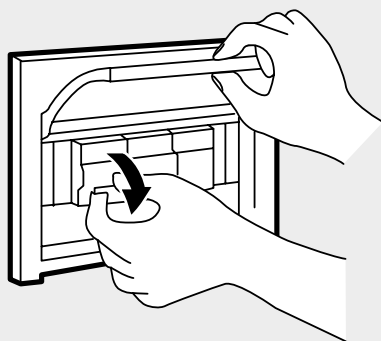

i

Ø 60

Ø 90

Ø 120

Ø 160

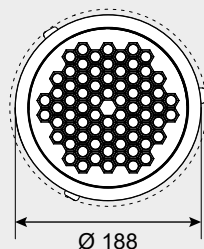
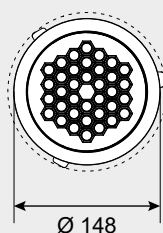
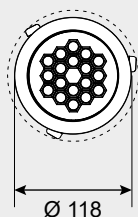
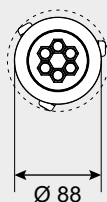
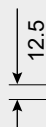
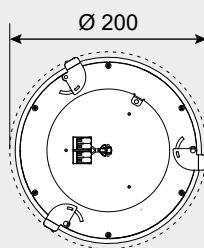
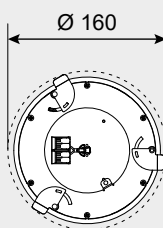
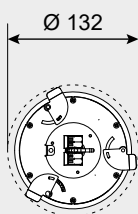
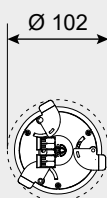

1a

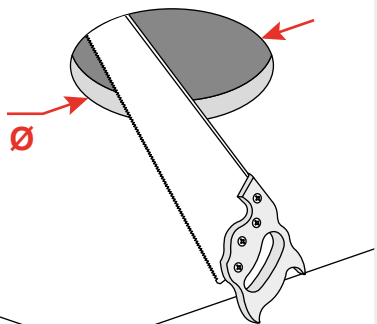

2a

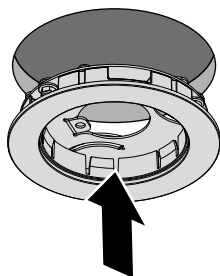

3a

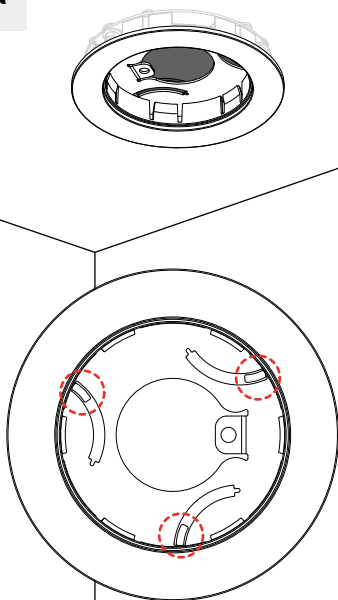

4a

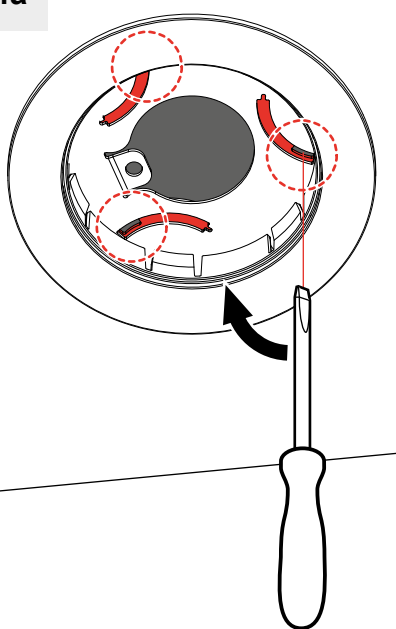

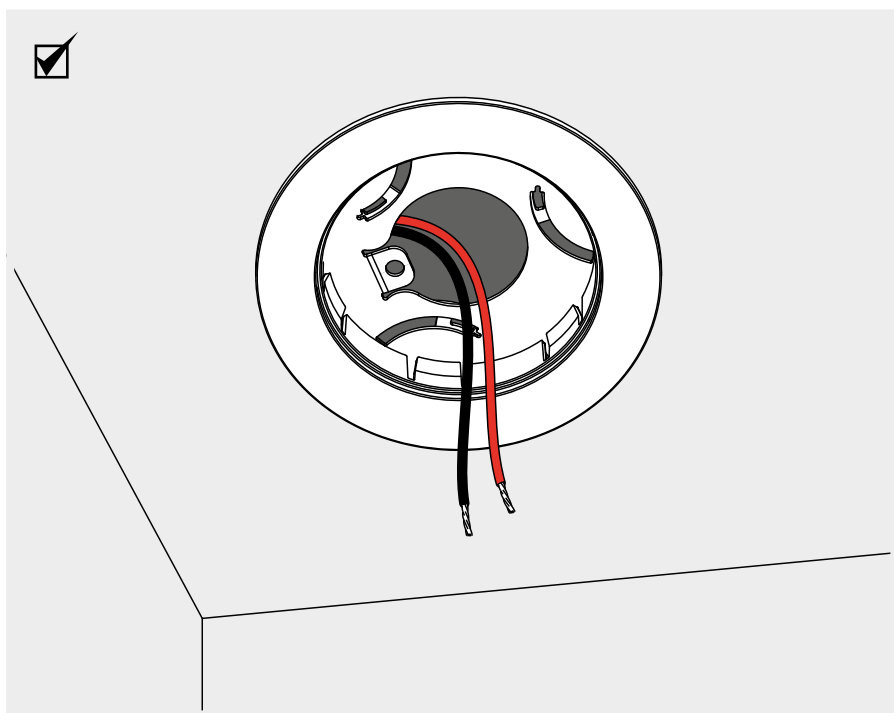
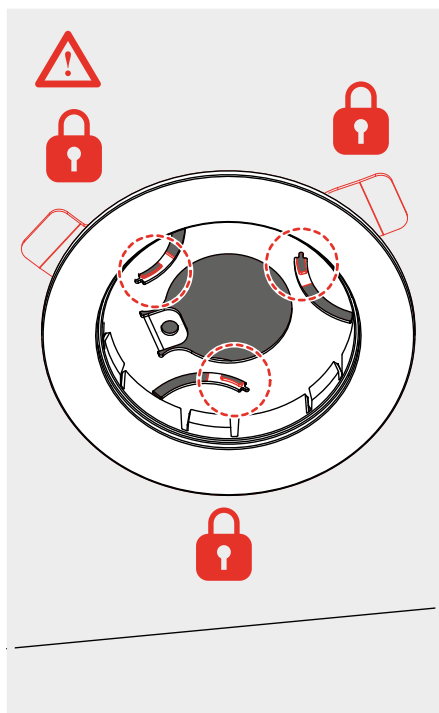
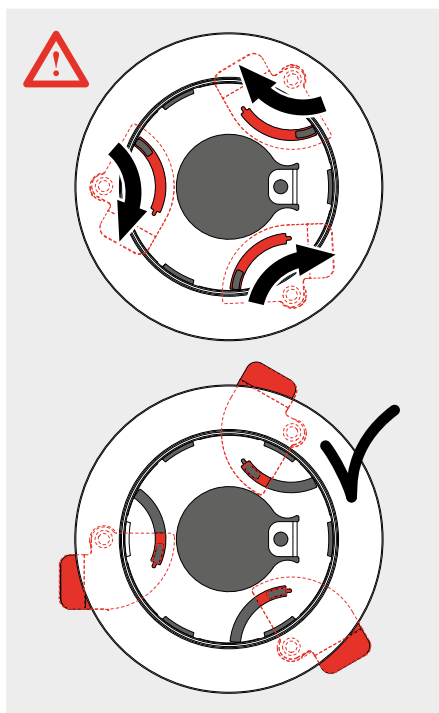

TRIMLESS FRAME

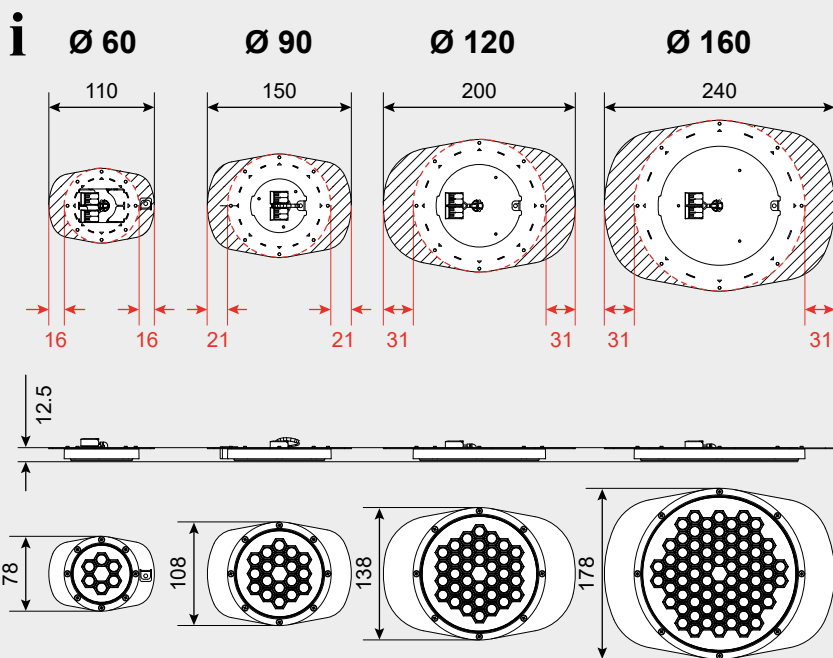
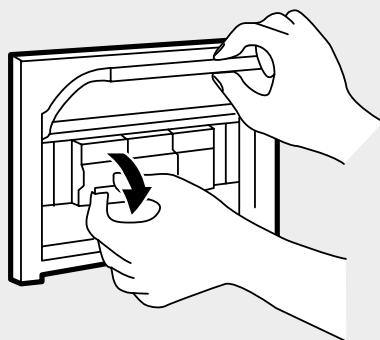

1b

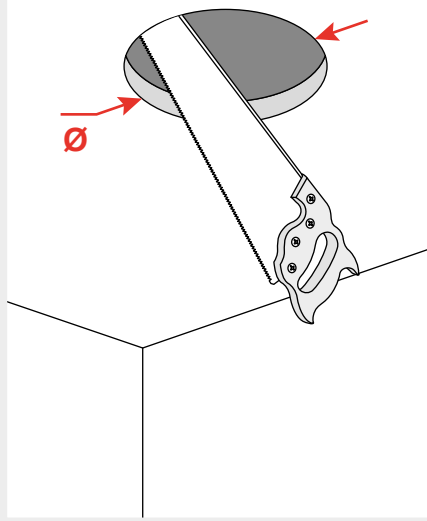

2b

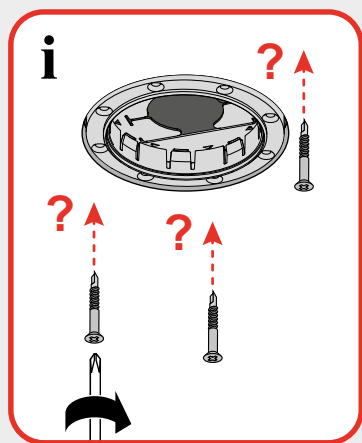
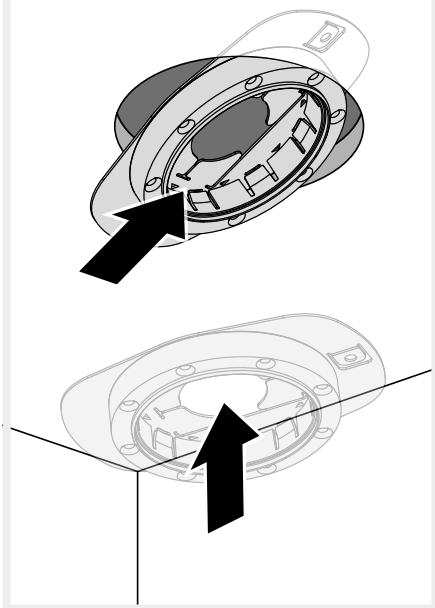

Ø 60

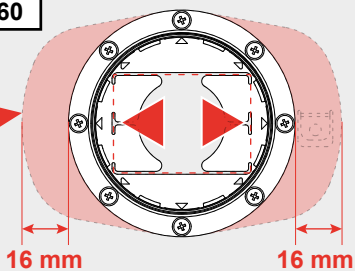

Ø 90-120-160

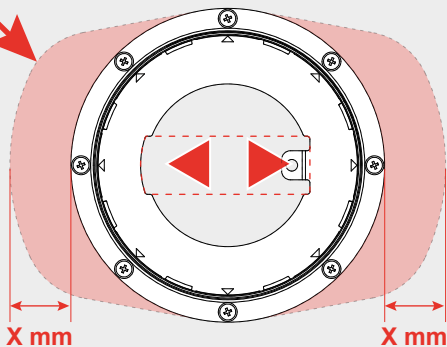

Ø	90	120	160
X [mm]	21	31	31

3b

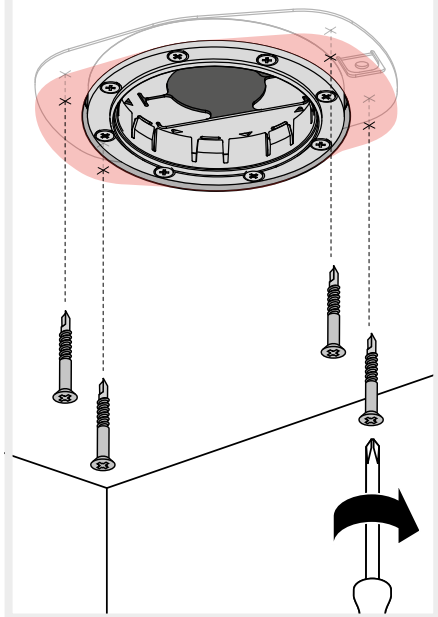

4b

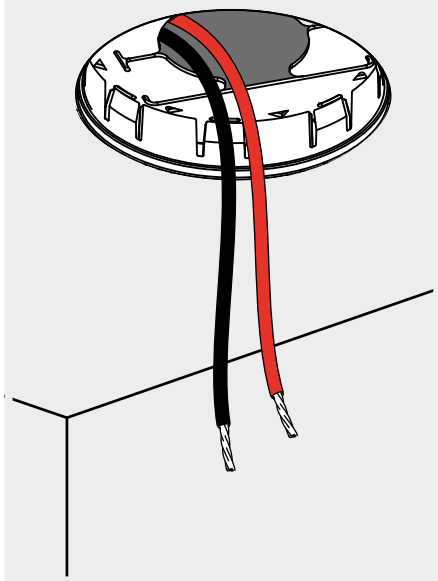
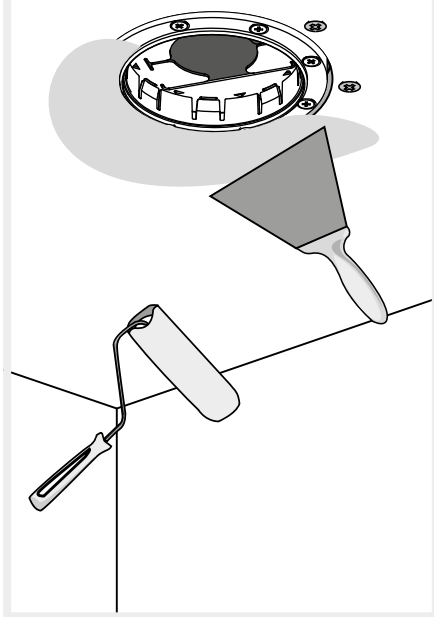

TRIM FRAME & TRIMLESS FRAME

5

OPTION 1

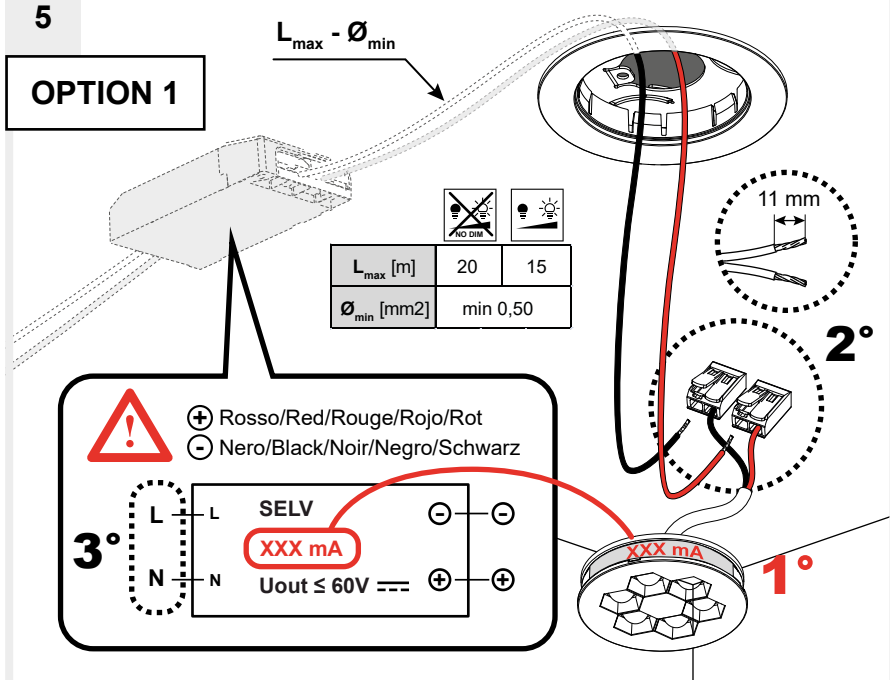

5

OPTION 2

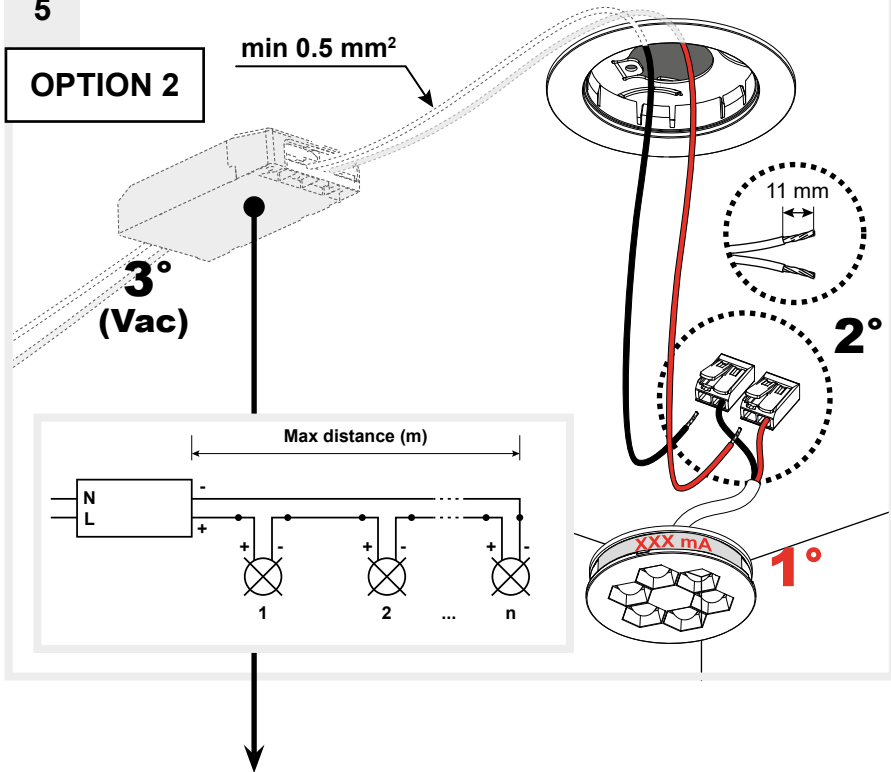

Helgoland sizes [Ø mm]	Remote driver type	Code	Driver dimensions			Circuit breaker	Max distance [m]	Current setting [mA]	V module	Devices nr.
			L [mm]	W [mm]	H [mm]					
60	ND	DV1037	146.5	42.5	22	A 16-30 B 16-50 C 16-70	20	300	8.5V	2 min 4 max
	DALI2 / 0-10 / PUSH	DV1126	111	52	22	A 16-30 B 16-50 C 16-70 D 16-100	15			1 min 5 max
	DALI2 / PUSH	DV1127	146.5	43.5	22		15			2 min 4 max
	APP & PUSH	DV1128APP	146.5	44	30		15			2 min 5 max
90	ND	DV1037	146.5	42.5	22	A 16-30 B 16-50 C 16-70	20	350	17V	1 min 2 max
	DALI2 / 0-10 / PUSH	DV1126	111	52	22	A 16-30 B 16-50 C 16-70 D 16-100	15			1 min 2 max
	APP & PUSH	DV1129APP	146.5	44	30		15			1 min 2 max

FOLLOWS ON NEXT PAGE

Helgoland sizes [Ø mm]	Remote driver type	Code	Driver dimensions			Circuit breaker	Max distance [m]	Current setting [mA]	V module	Devices nr.
			L [mm]	W [mm]	H [mm]					
120	ND	DV1037	146.5	42.5	22	A 16-30 B 16-50 C 16-70	20	500	17V	1 min 2 max
	DALI2 / 0-10 / PUSH	DV1126	111	52	22	A 16-30 B 16-50 C 16-70 D 16-100	15			1 min 2 max
	APP & PUSH	DV1104APP	124	79	22	A 16-20 B 16-30 C 16-50	15			1 min 2 max
160	ND	DV1037	146.5	42.5	22	A 16-30 B 16-50 C 16-70	20	500	34V	1 max
	DALI2 / 0-10 / PUSH	DV1126	111	52	22	A 16-30 B 16-50 C 16-70 D 16-100	15			1 max
	APP & PUSH	DV1104APP	124	79	22	A 16-20 B 16-30 C 16-50	15			1 max

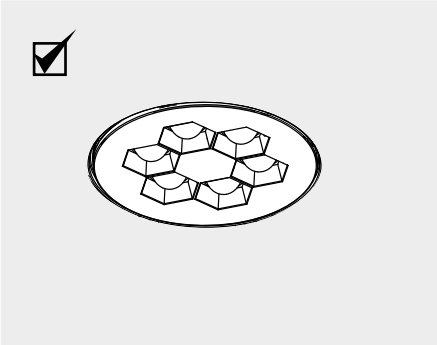
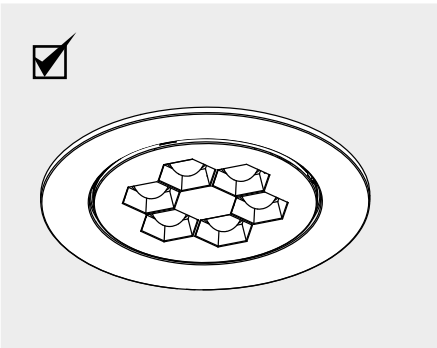
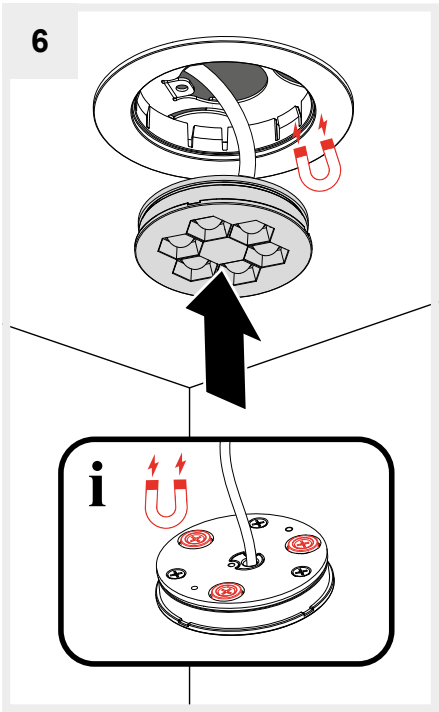

US / CANADA ONLY

Ø 60

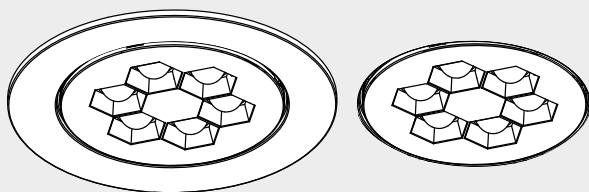

TRIM FRAME

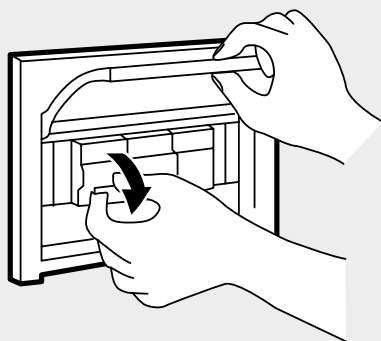

i

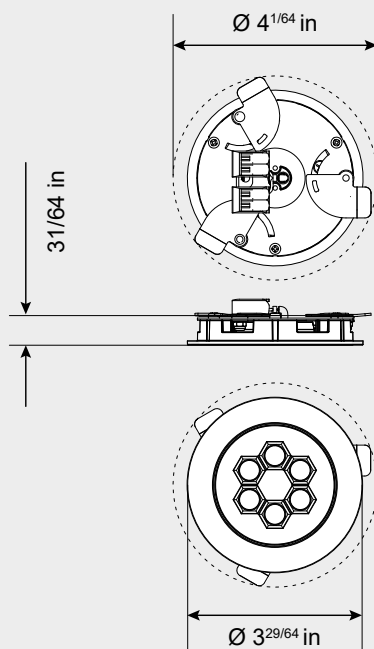

1a

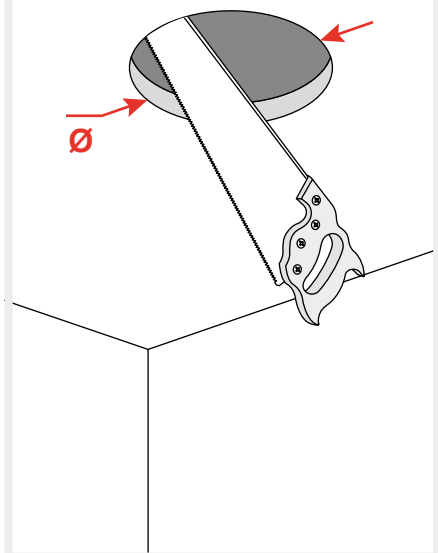

2a

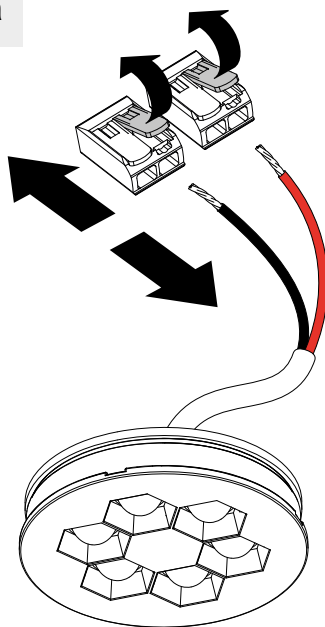

3a

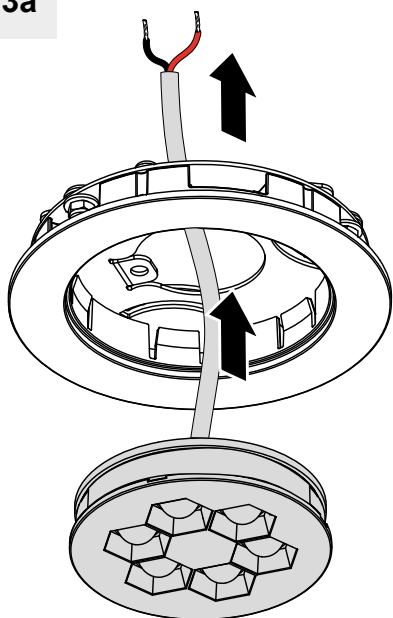

4a

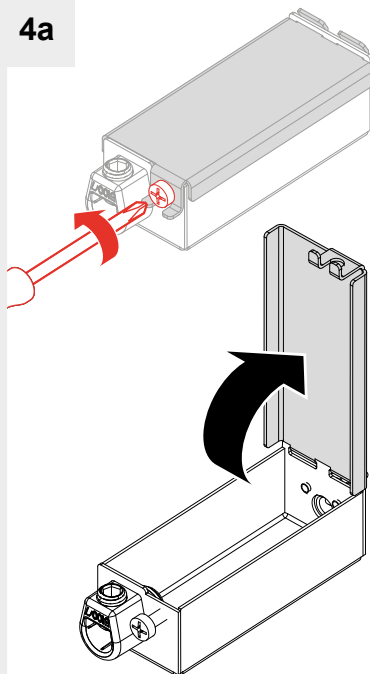

5a

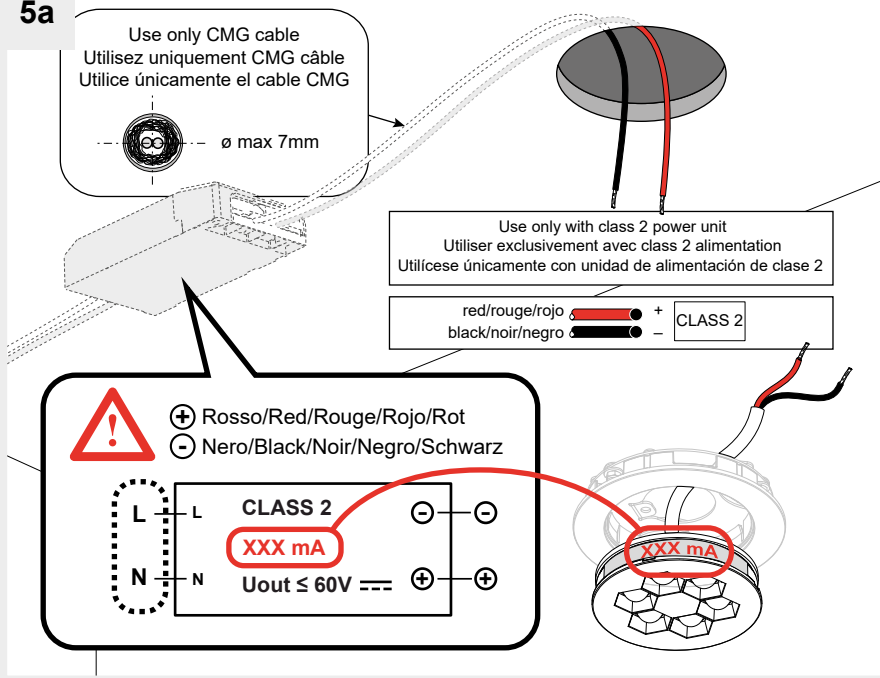

6a

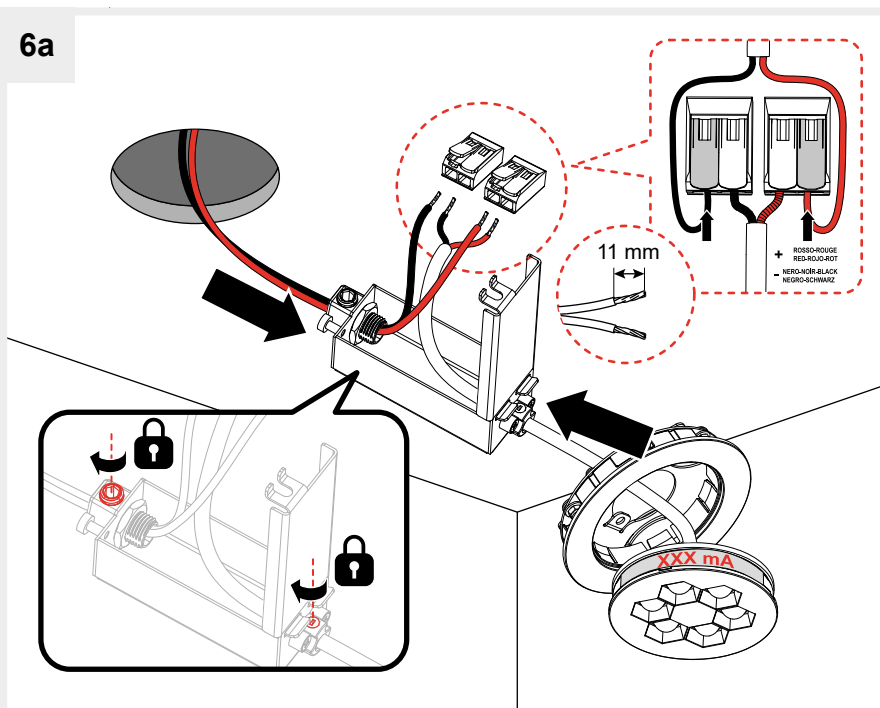

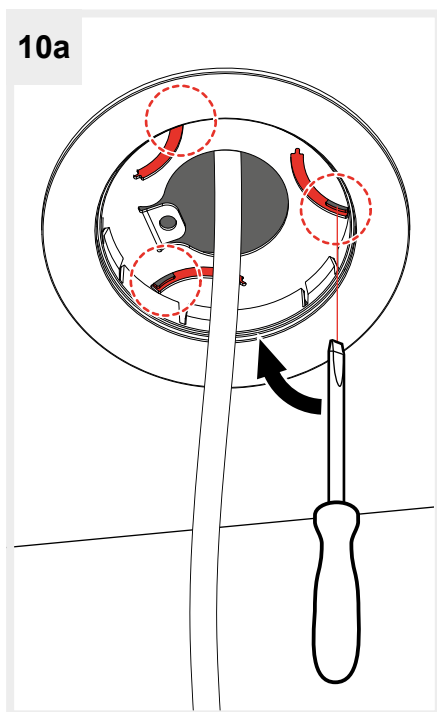
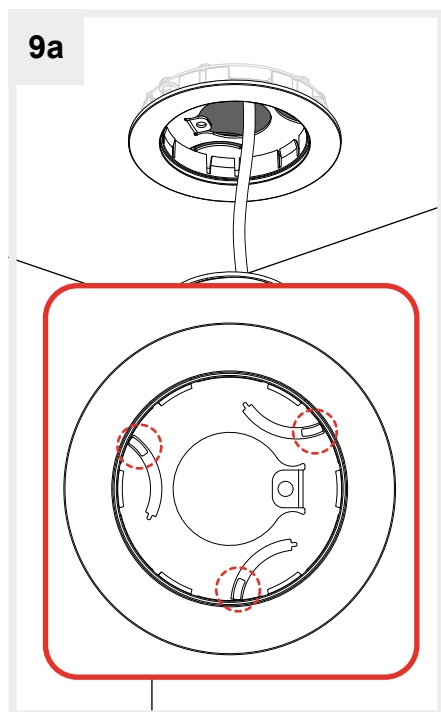
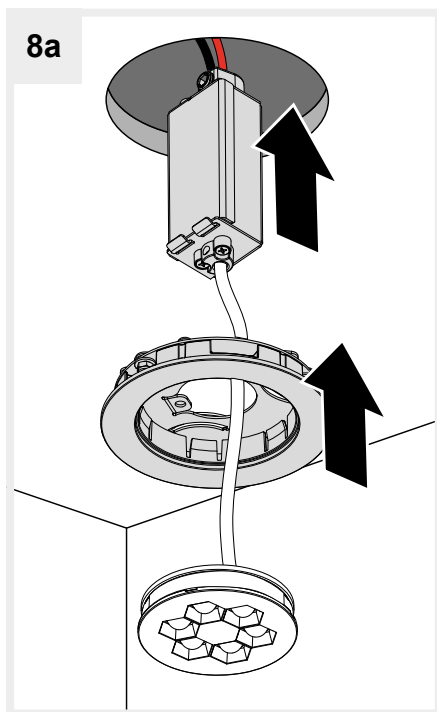
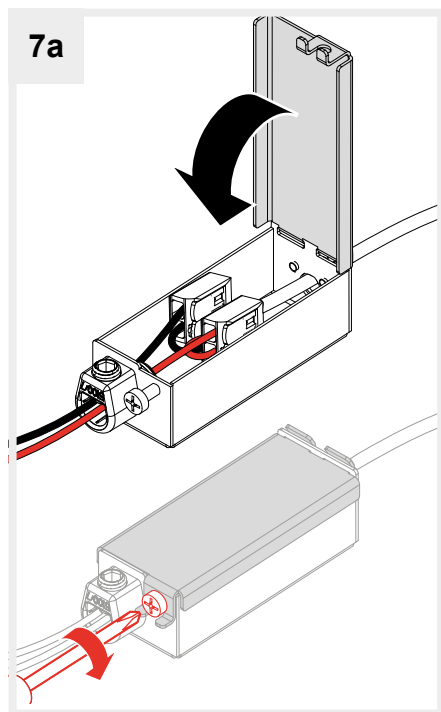

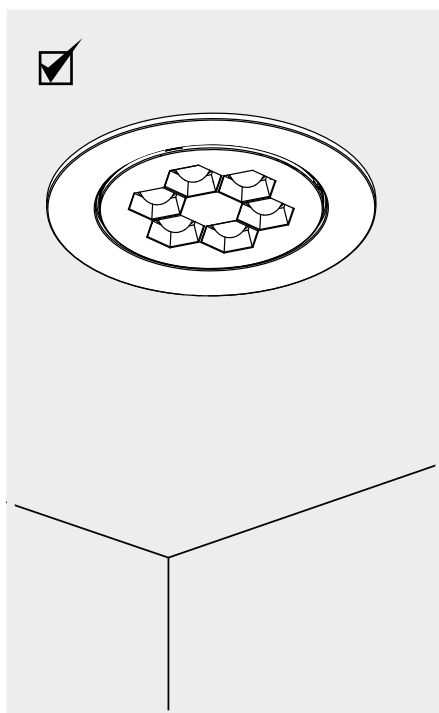
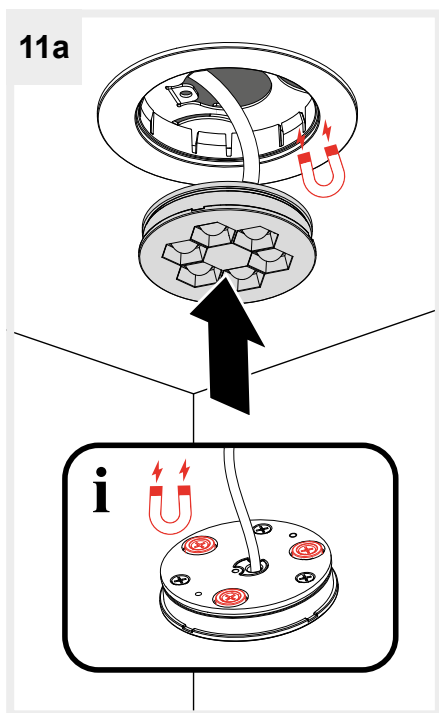
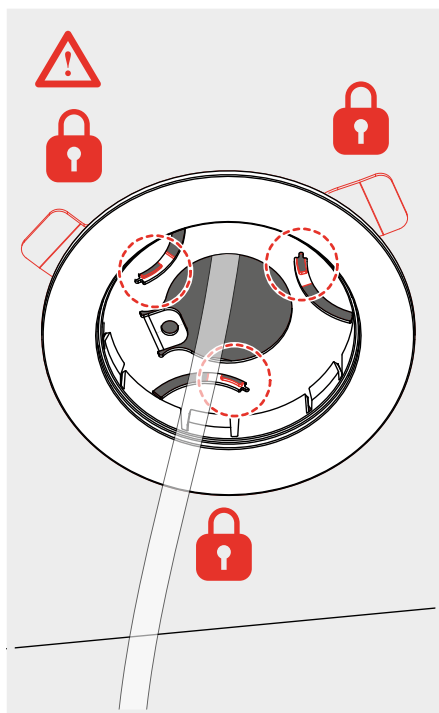
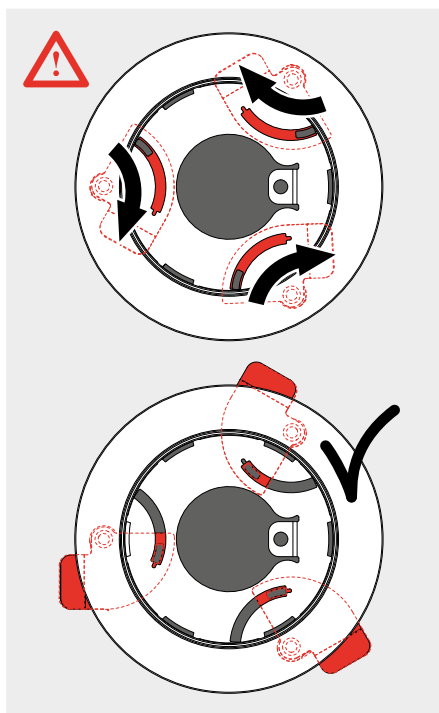

TRIMLESS FRAME

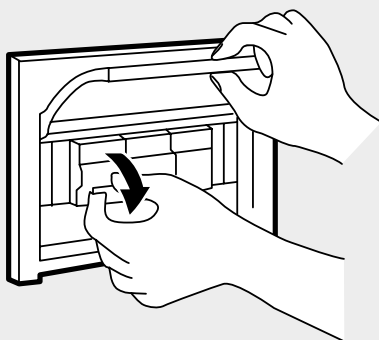

i

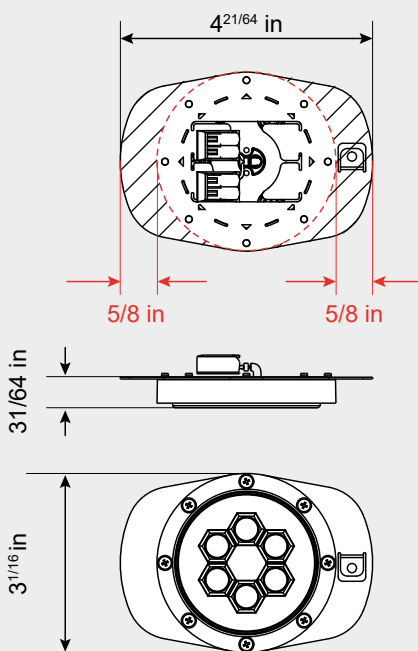

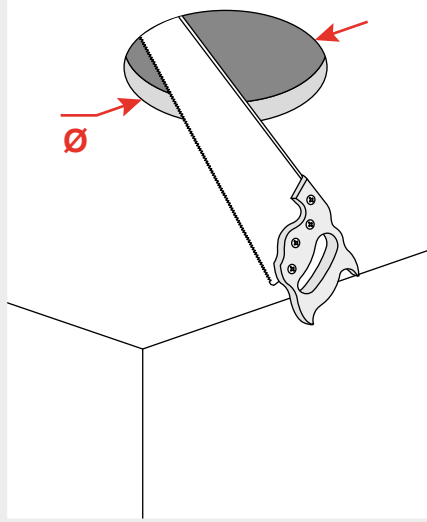
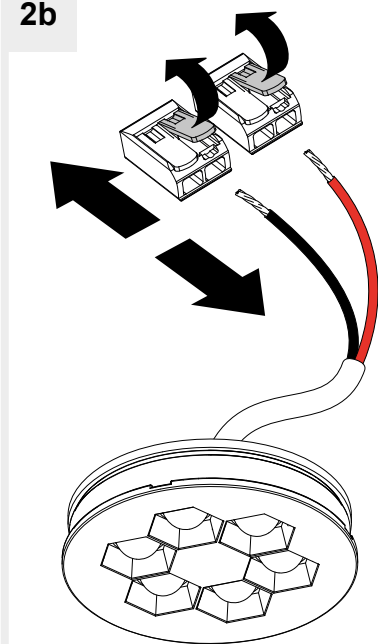
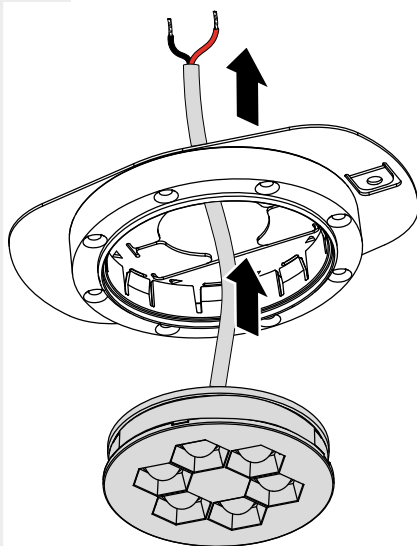
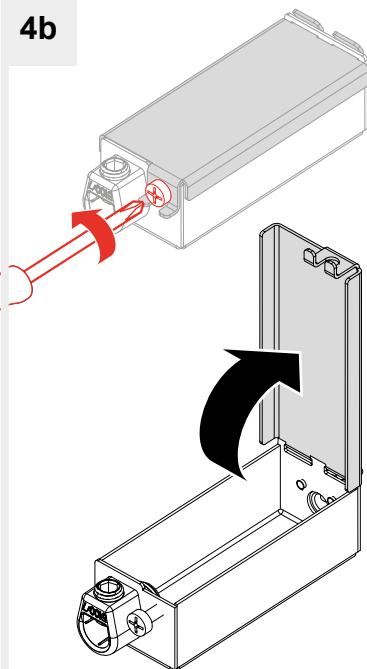
1b**2b****3b****4b**

5b

Use only CMG cable
Utilisez uniquement CMG câble
Utilícese únicamente el cable CMG



Ø max 7mm

Use only with class 2 power unit
Utiliser exclusivement avec class 2 alimentation
Utilícese únicamente con unidad de alimentación de clase 2

red/rouge/rojo + CLASS 2
black/noir/negro -



⊕ Rosso/Red/Rouge/Rojo/Rot
⊖ Nero/Black/Noir/Negro/Schwarz

L
N

L
N

CLASS 2

XXX mA

U_{out} ≤ 60V ===

⊖
⊕

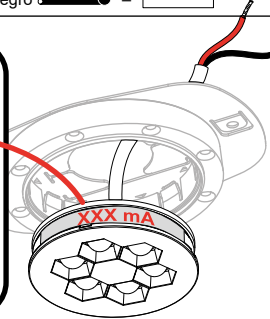

6b

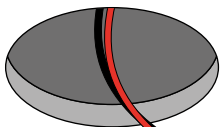

11 mm

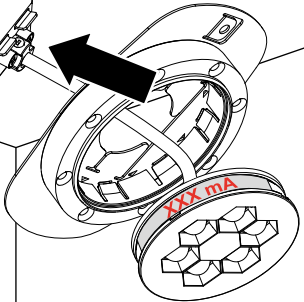
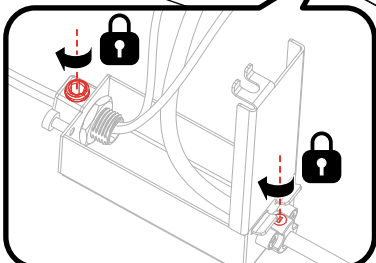
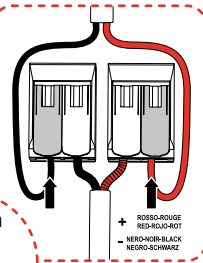

7b

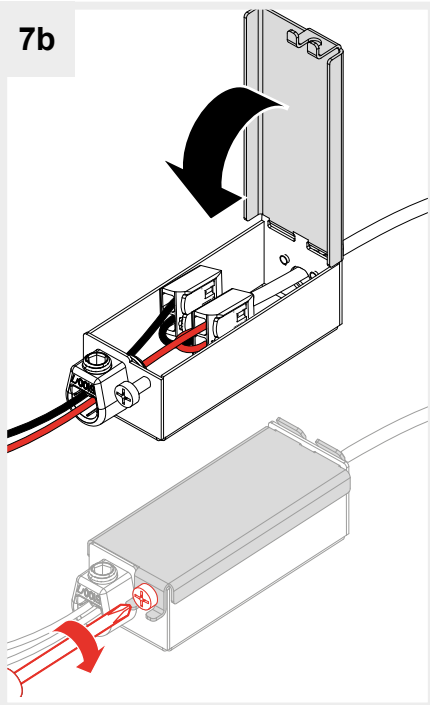

8b

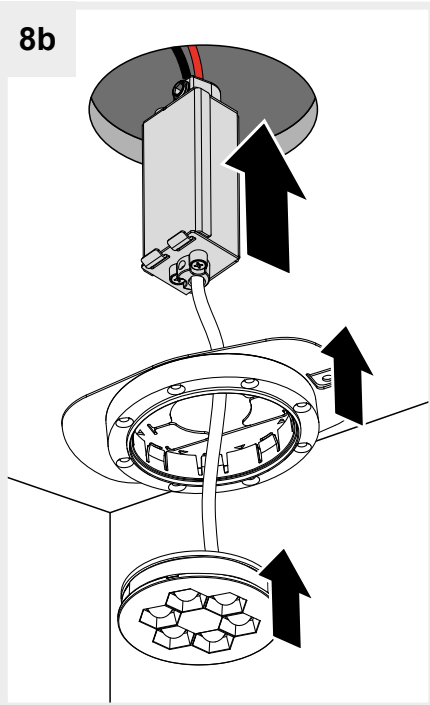

9b

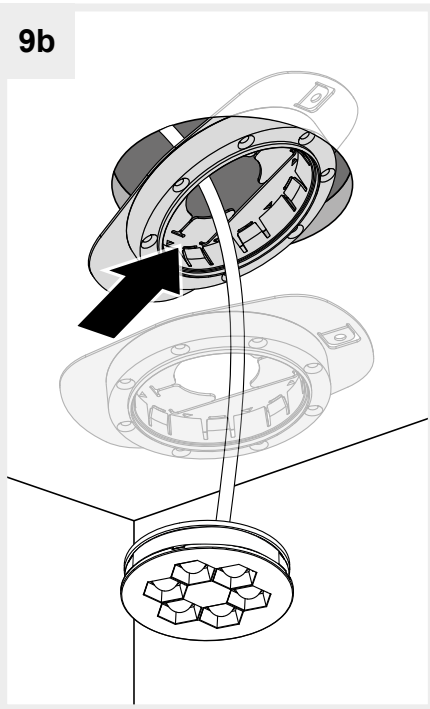

i

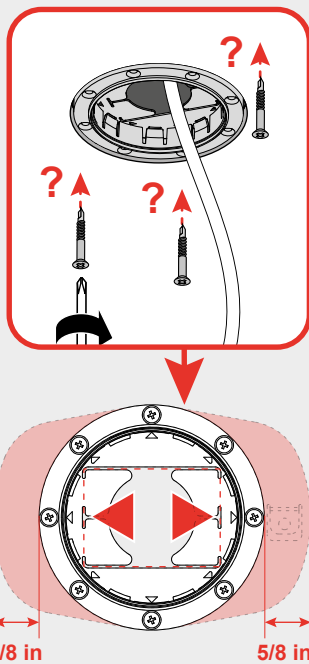

10b

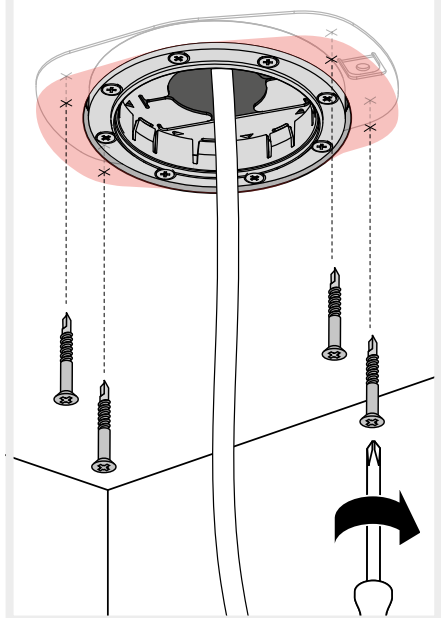

11b

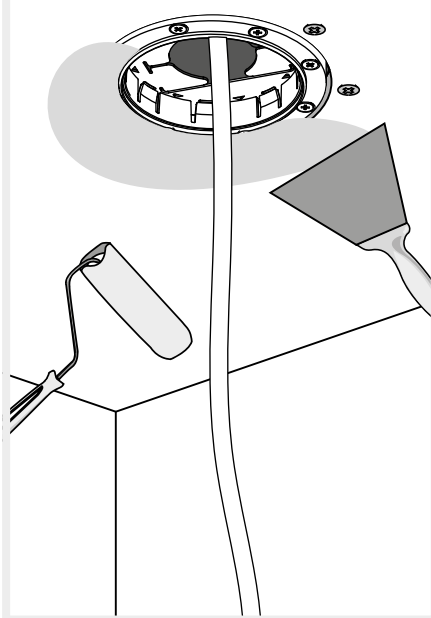

12b

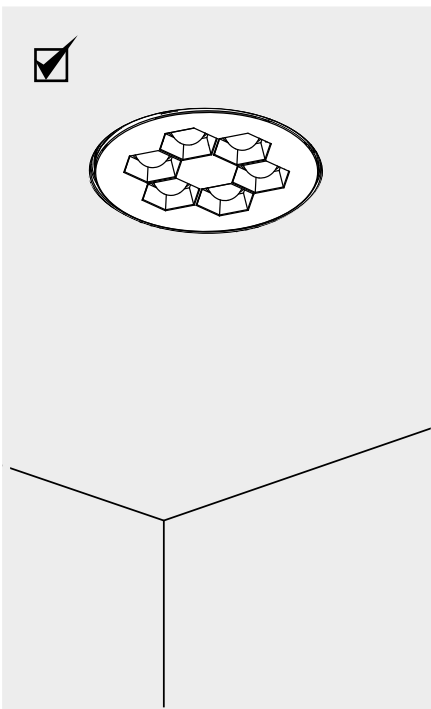
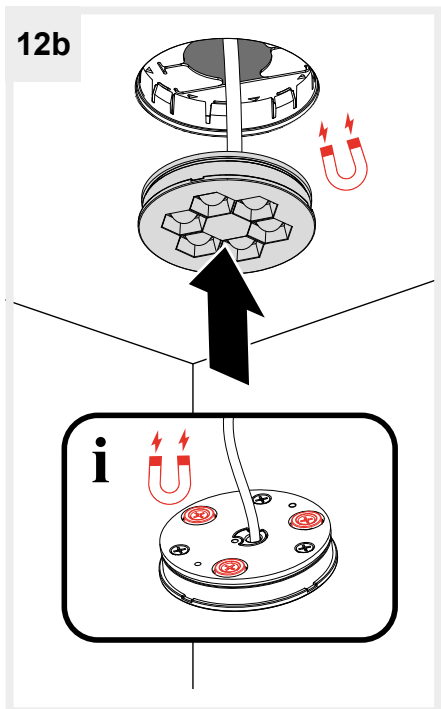

US / CANADA ONLY

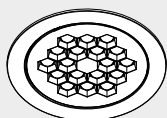

Ø 90

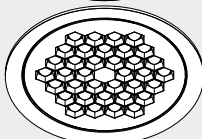
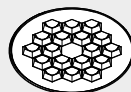

Ø 120

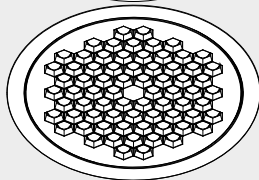
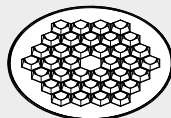

Ø 160

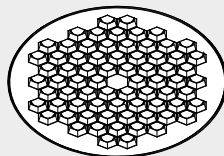

TRIM FRAME

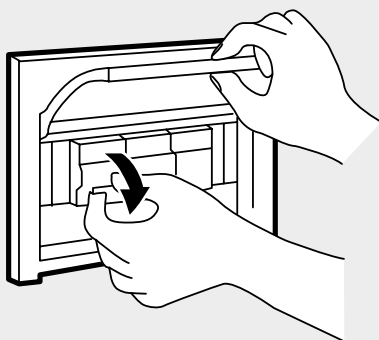

i

Ø 90

Ø 120

Ø 160

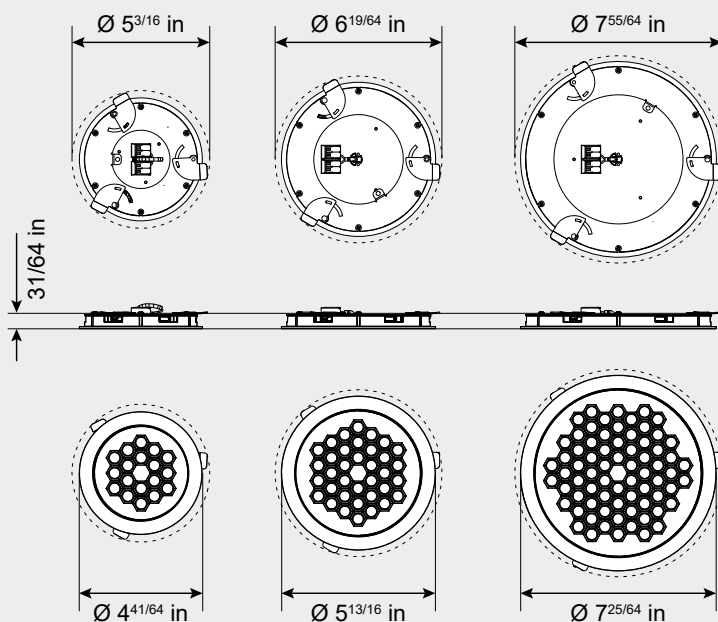

1a

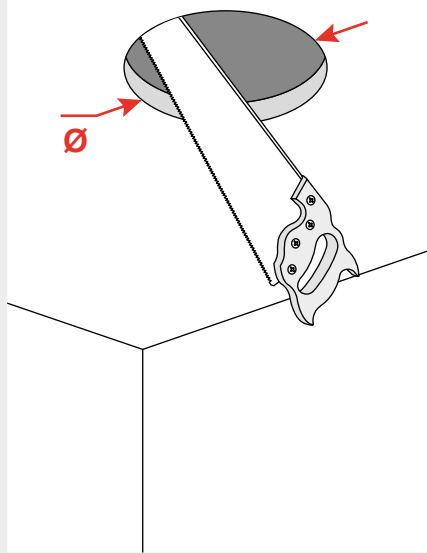

2a

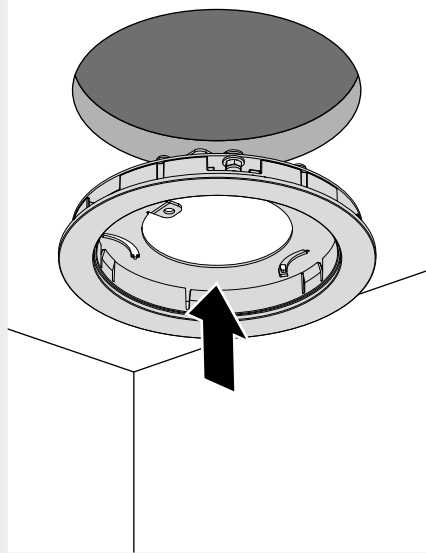

3a

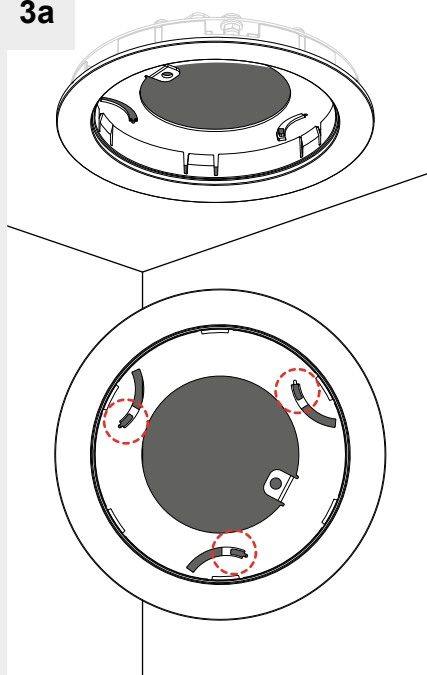

4a

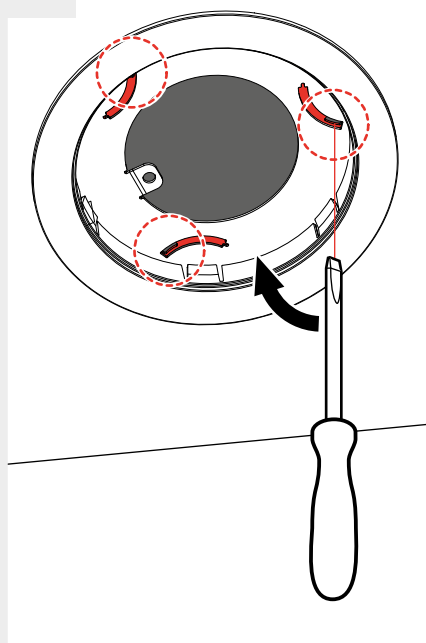

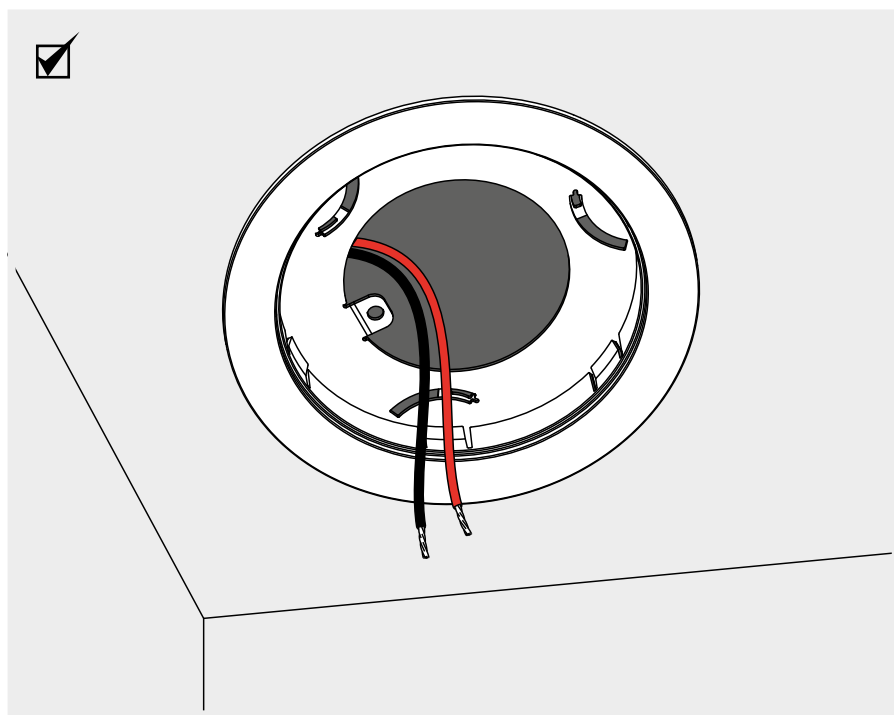
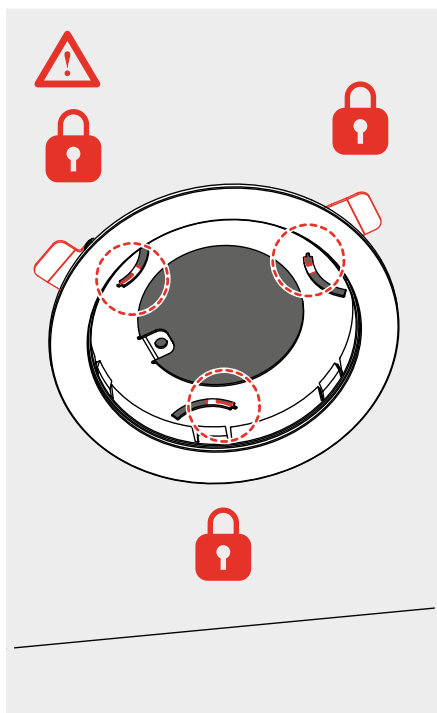
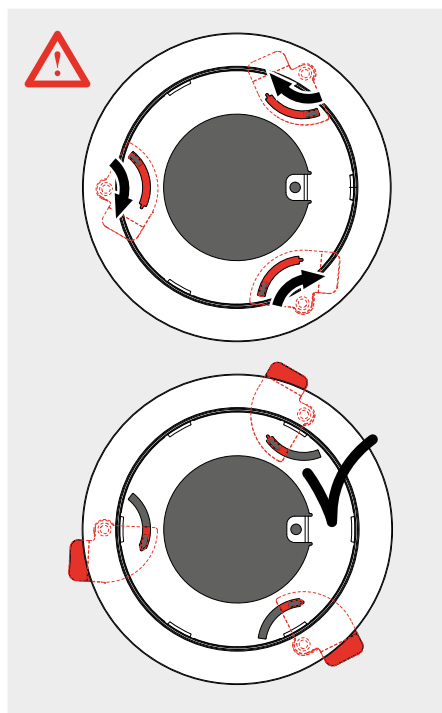

TRIMLESS FRAME

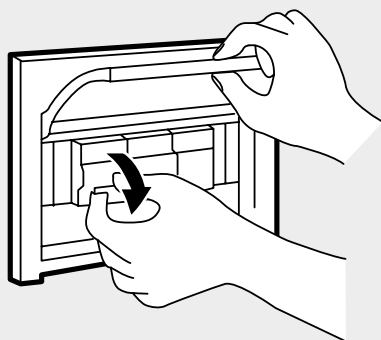

i

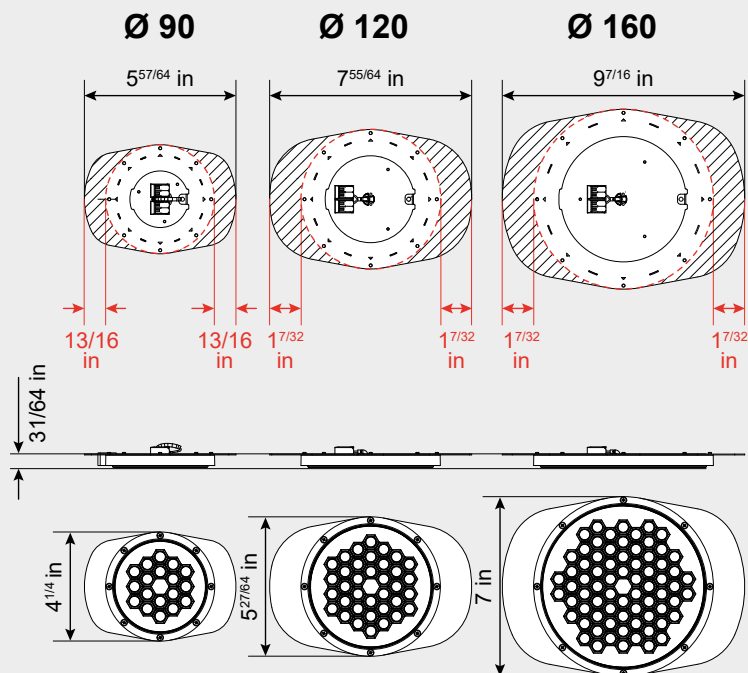

1b

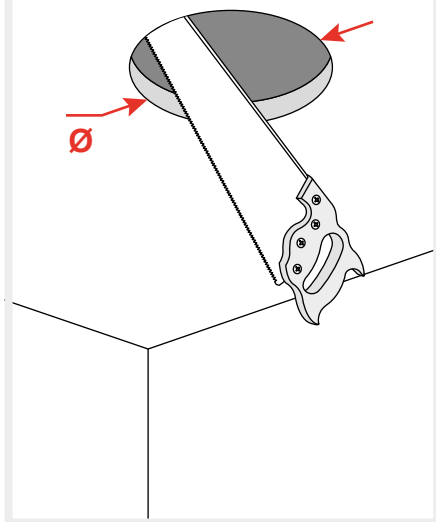

2b

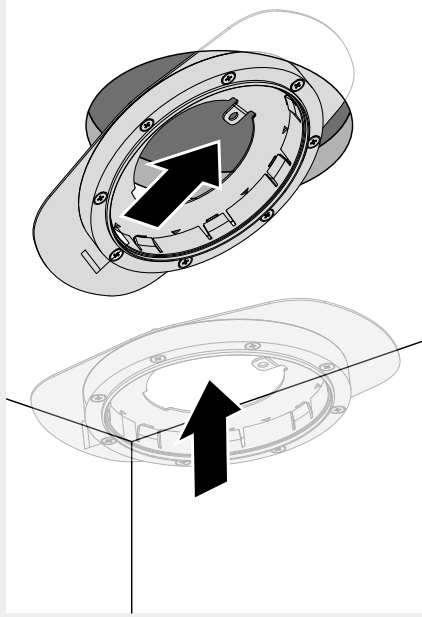

i

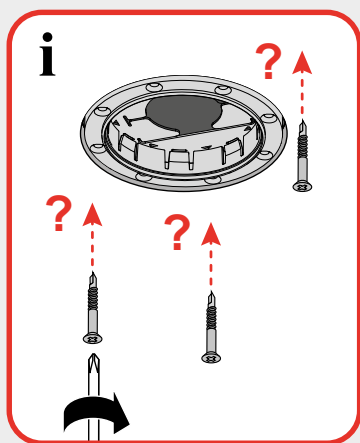

Ø 90-120-160

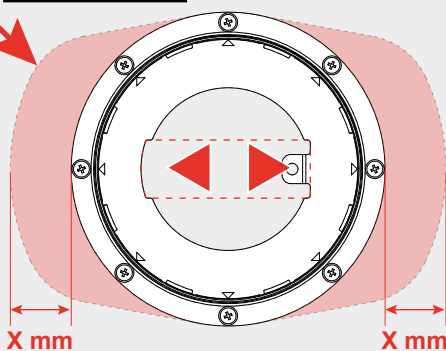

Ø	90	120	160
X [mm]	21	31	31

3b

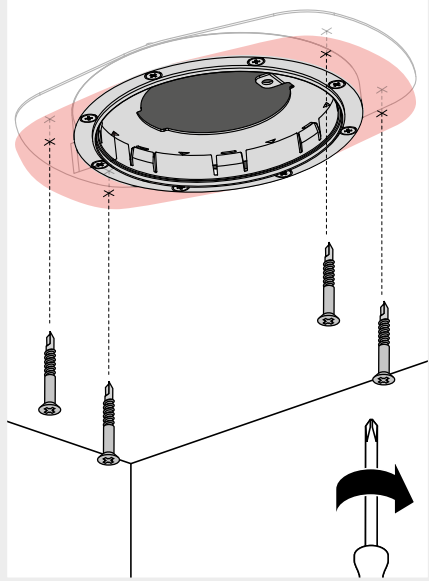

4b

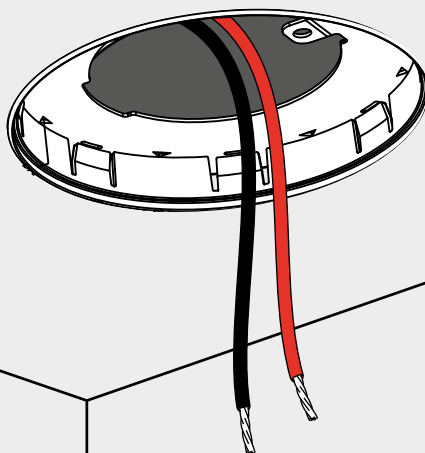
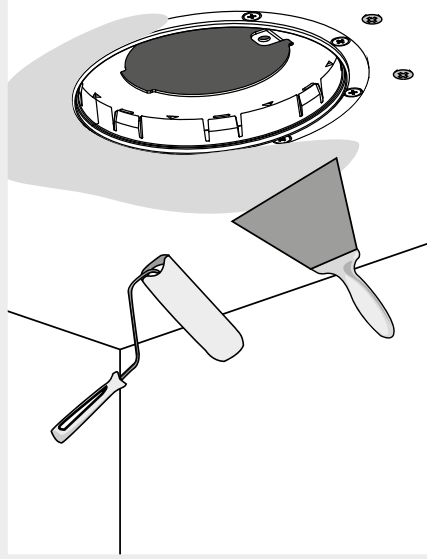

TRIM FRAME & TRIMLESS FRAME

5

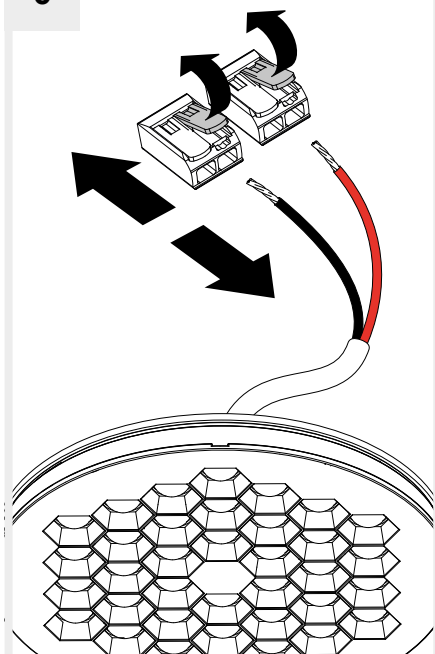

6

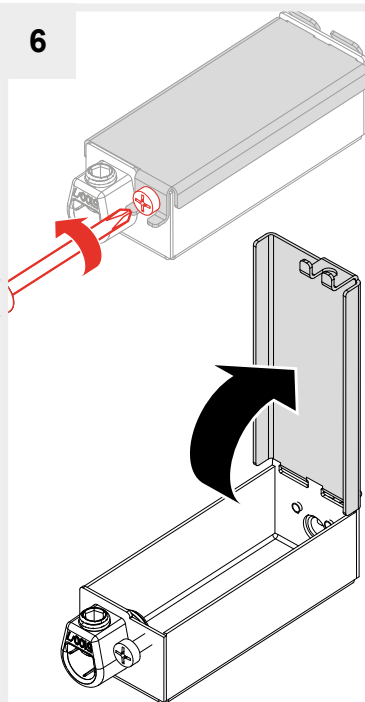

7

Use only CMG cable
Utilisez uniquement CMG câble
Utilice únicamente el cable CMG

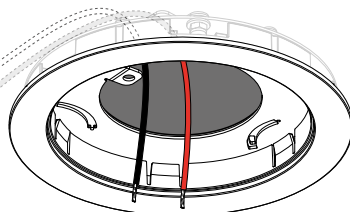

Use only with class 2 power unit
Utiliser exclusivement avec class 2 alimentation
Utilícese únicamente con unidad de alimentación de clase 2

red/rouge/rojo + CLASS 2
black/noir/negro -



⊕ Rosso/Red/Rouge/Rojo/Rot
⊖ Nero/Black/Noir/Negro/Schwarz

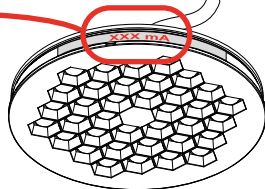
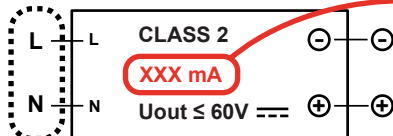

8

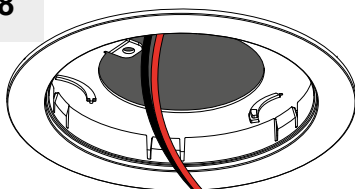

11 mm

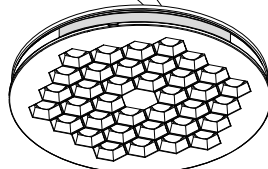
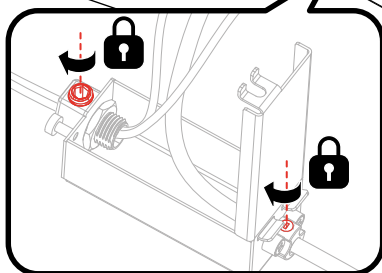
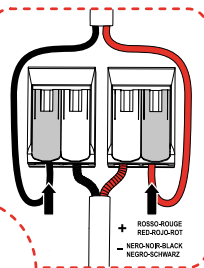

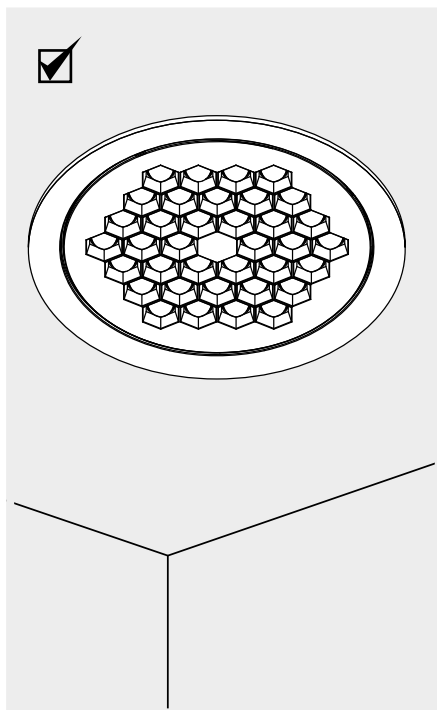
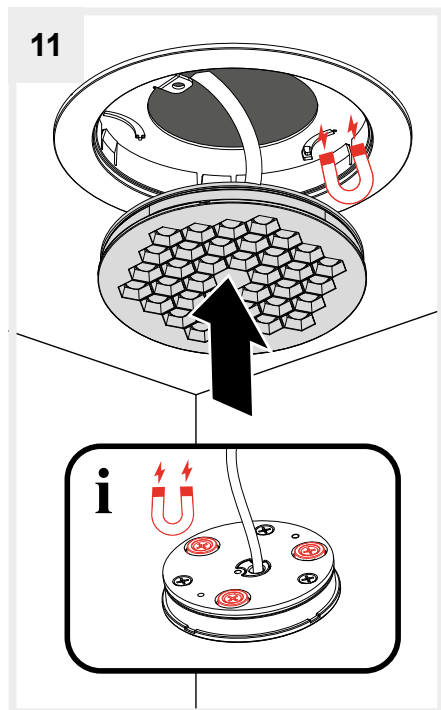
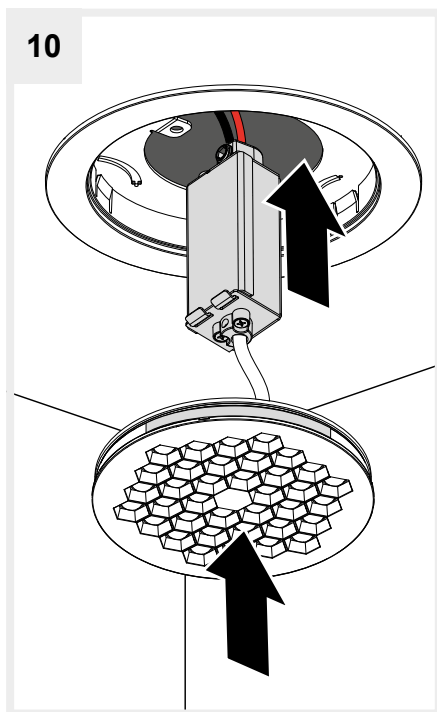
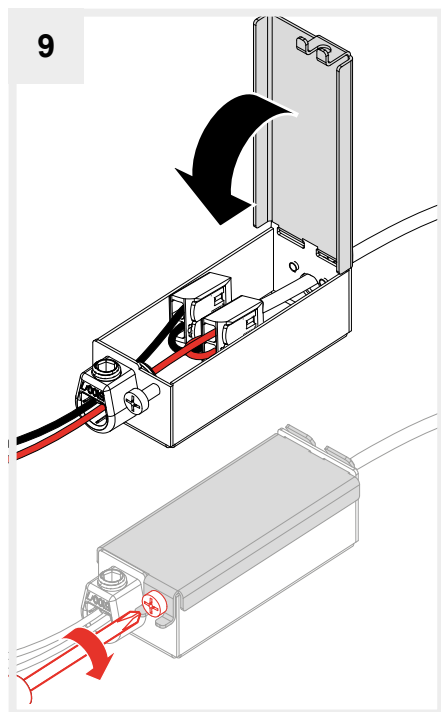

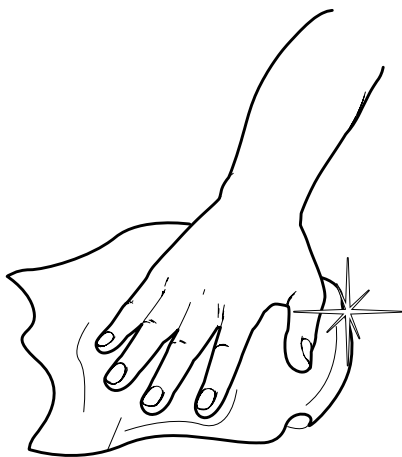
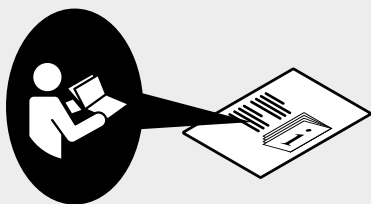
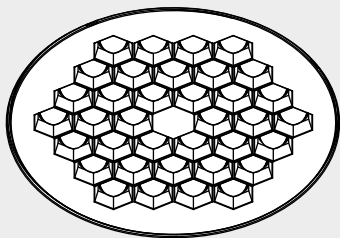



1

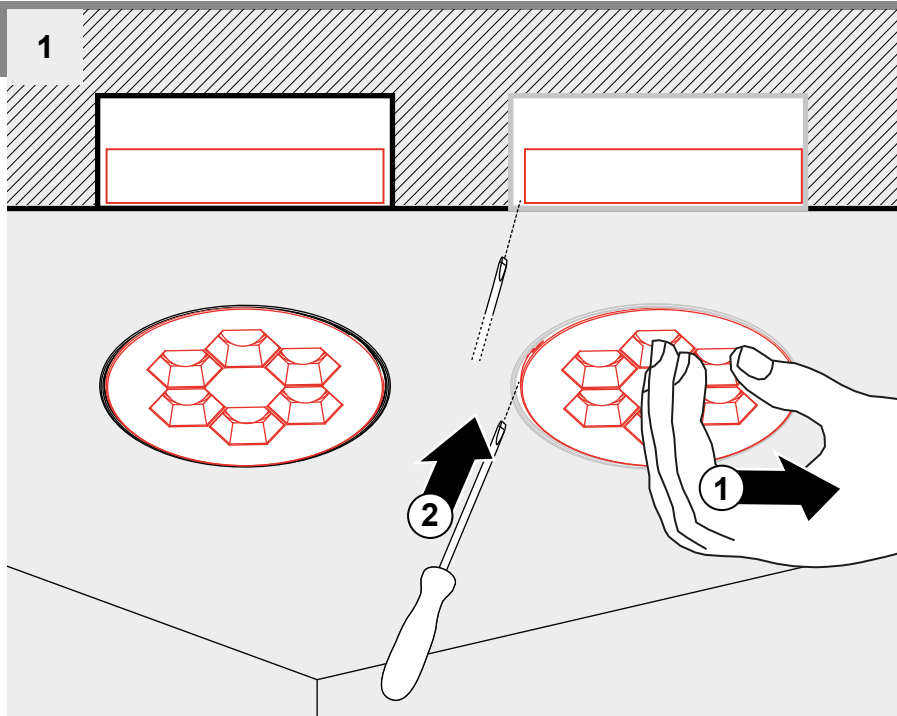

2

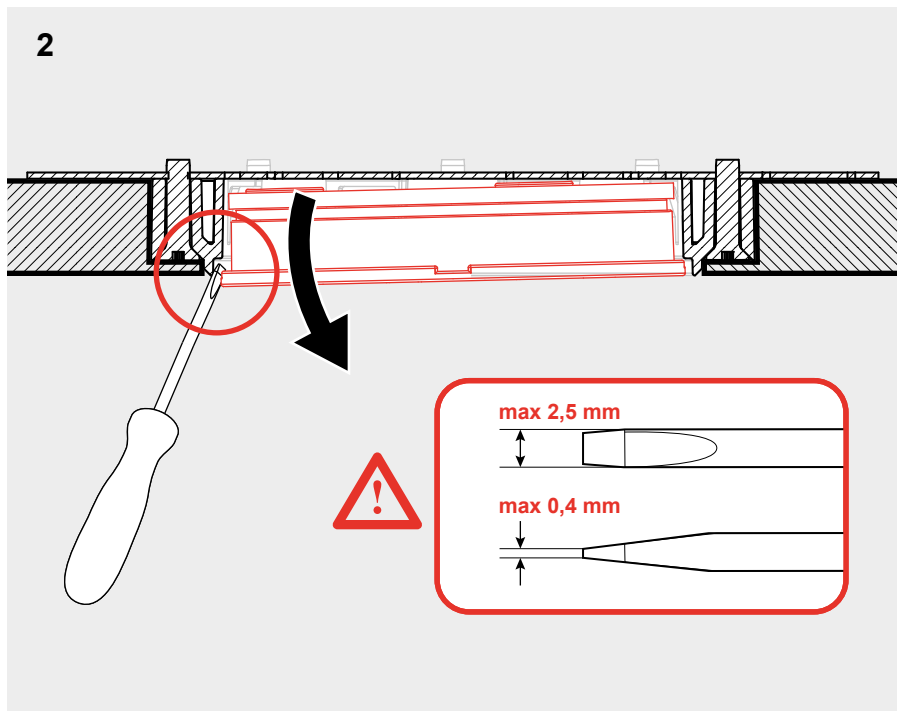

	CODES			FIXED II		
				Ø 60	Ø 90	
				AX00 __ 4 AX01 __ 4	AX05 __ 4 AX06 __ 4	
FRAMES FOR PLASTERBOARD THICKNESS = 12.5 mm	TRIM	Ø 60	AX5010_	✓		
		Ø 90	AX5510_		✓	
		Ø 120	AX6010_			
		Ø 160	AX6510_			
	TRIMLESS	Ø 60	AX50000	✓		
		Ø 90	AX55000		✓	
		Ø 120	AX60000			
		Ø 160	AX65000			
FRAMES FOR PLASTERBOARD THICKNESS ≠ 12.5 mm	TRIM	Ø 60	AX5210_	✓ + AX90500		
		Ø 90	AX5710_		✓ + AX90600	
		Ø 120	AX6210_			✓
		Ø 160	AX6710_			
	TRIMLESS	Ø 60	AX52000	✓ + AX90500		
		Ø 90	AX57000		✓ + AX90600	
		Ø 120	AX62000			✓
		Ø 160	AX67000			



FOR INSTALLATION ON
PLASTERBOARD OF
THICKNESSES

≠ 12.5 mm

HELGOLAND RECESSED SPOTLIGHTS

P20		FIXED IP44		ADJ	
Ø 120	Ø 160	Ø 90	Ø 120	Ø 90	Ø 120
AX10__4	AX15__4	AX92__4	AX94__4	AX07__4	AX12__4
AX11__4	AX16__4	AX93__4	AX95__4	AX08__4	AX13__4
		X		X	
✓			X		X
	✓				
		X		X	
✓			X		X
	✓				
		✓ + AX90600		✓	
✓ + AX90700			✓ + AX90700		✓
	✓ + AX90800				
		✓ + AX90600		✓	
✓ + AX90700			✓ + AX90700		✓
	✓ + AX90800				

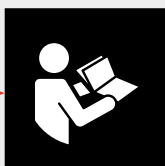

Y513002229

Artemide®



Artemide

via Bergamo, 18
20006 Pregnana M.se (MI)
ITALIA

tel. +39 02 935 181
fax +39 02 935 90 254
fax +39 02 935 90 496

www.artemide.com

VAT IT00846890150

Artemide Inc.

250 Karin Lane
Hicksville, NY 11801

tel. 631 694 9292
Toll Free 1-877-Art-9111
Fax 631 694 9275

www.artemide.net

cod. Y513002019D